



## DS-32RS370 DC SPUR GEAR MOTOR Series

Main voltage: 6VDC, 12VDC, 24VDC

Typical applications:

Garbage disposers, Slot machine, Peristaltic pump, Angular telescope, Automatic door, Electric advertising, Medical equipment, ATM bank automatic system, Household appliances, Automatic actuator, Office equipment.

Weight: 120~160g/pcs(approx)

Packing details: CTN size: 28X26XH22.5cm 60pcs/CTN G.W. 8Kgs

### APPEARANCE SIZE

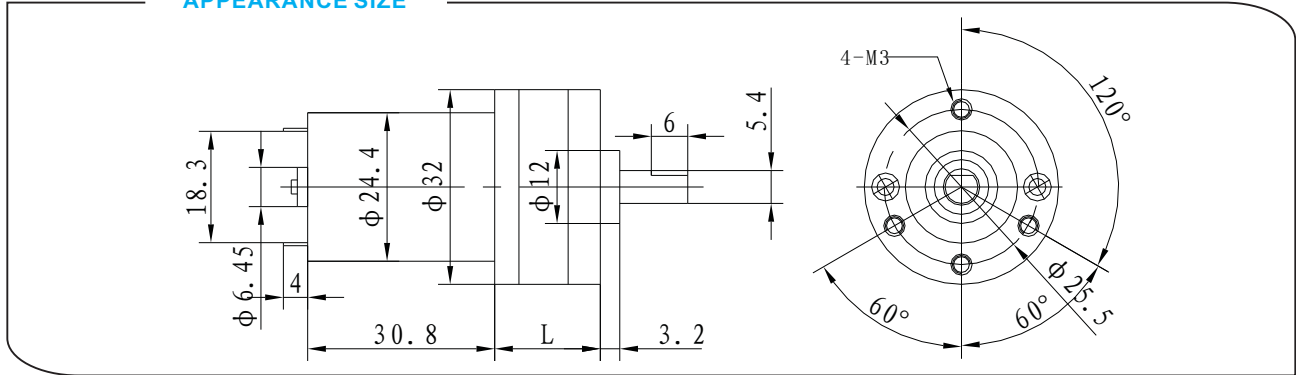

### Gearbox Data:

Number of stages	2 stages reduction	3 stages reduction	4 stages reduction	5 stages reduction	6 stages reduction	7 stages reduction
Reduction ratio	5.75	12.65	27.83	40, 61.23	76.4, 101.4, 117, 134.7	145.8, 168, 193.6, 223.2, 257.2, 296.3, 329.3
Gearbox length "L" mm	17.5	20	22.5	25	27.5	30
Max. Running torque	1.8Kgf·cm	1.8Kgf·cm	4.5Kgf·cm	4.5Kgf·cm	7Kgf·cm	7Kgf·cm
Max. Gear breaking torque	5.5Kgf·cm	5.5Kgf·cm	12.5Kgf·cm	12.5Kgf·cm	20Kgf·cm	20Kgf·cm
Max. Gearing efficiency	81%	73%	65%	59%	53%	47%

Other reduction ratio please telephone or e-mail to our engineering department.

### Motor Data:

Motor name	Rated Volt. V	No load		Load torque				Stall torque	
		Current	Speed	Current	Speed	Torque	Output power	Torque	Current
		mA	r/min	mA	r/min	gf·cm	W	gf·cm	A
RS-370063000	6	≤43	3000	≤80	2200	15	0.35	68	0.52
RS-370064500	6	≤56	4500	≤100	3300	28	0.9	108	0.86
RS-370066000	6	≤85	6000	≤120	4500	35	1.6	143	1.25
RS-370123000	12	≤25	3000	≤72	2200	22	0.56	89	0.42
RS-370124500	12	≤35	4500	≤126	3300	30	1.03	115	0.69
RS-370126000	12	≤50	6000	≤220	4500	38	1.7	165	0.98

Remarks: After connecting motor and gearbox (named gear motor), the output torque of gear motor = driving motor torque \* gear reduction ration \* gearing efficiency; Output speed of gear motor = Driving motor speed / gear reduction ration.

### NOTE:

1. Gear motor named methods: e.g. DS-32RS370063000-40K, as for Driving Motor, please refer to the motor data of RS-370063000; Gearbox, please refer to gearbox data of reduction ration 40. Related to the gear motor output speed & torque, please refer to the remarks in driving motor data;
2. Motor can be installed with magnetic encoder, for more details, pls refer to our company website;
3. Standard output shaft after reducing: φ6.0mm, other sizes of the output shaft can be made as client's request;
4. The gear materials can be plastic, powder metallurgy, or 45# steel after heat-treatment;