

## DS-95SS555 DC SPUR GEAR MOTOR Series

Main voltage: 6VDC、12VDC、24VDC

Typical applications:

Auto shutter, Money detector, Binding machine, Automatic TV rack, Packing bank note machine, Limelight, Tissue machine, Office equipment, Household appliances, Automatic actuator.

Weight: 120~160g/pcs(approx)

Packing details: CTN size: 55X35XH18cm 24pcs/CTN G.W. 15Kgs

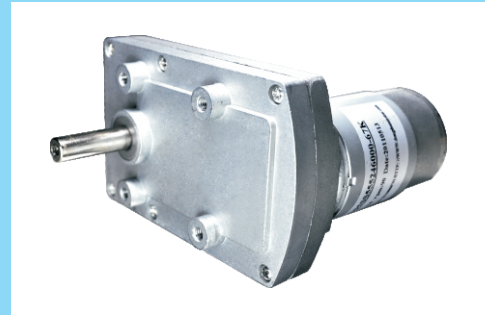

### APPEARANCE SIZE

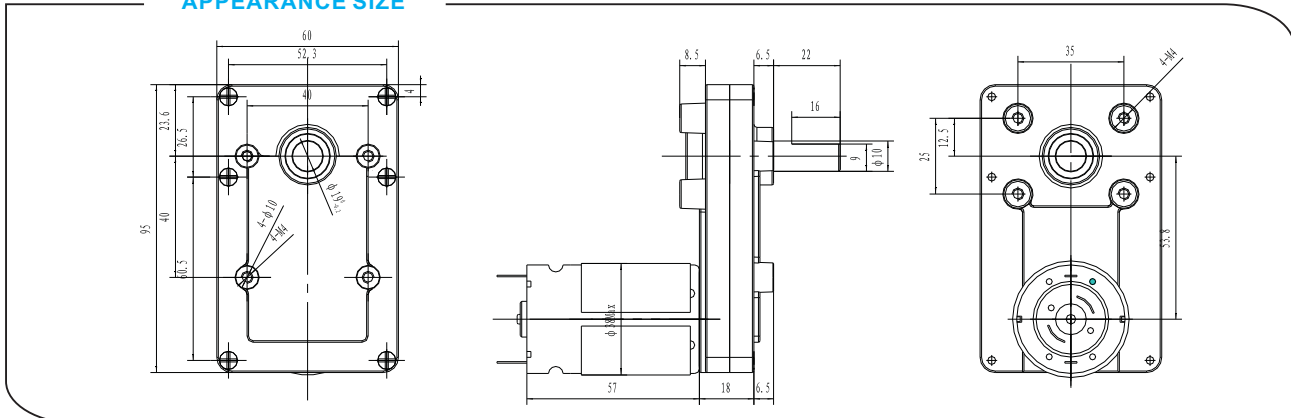

### Gearbox Data:

Number of stages	3 stages reduction	4stages reduction	5 stages reduction
Reduction ratio	36、66、94	149、196 211 277 394	624、830、1166
Max. Running torque	5Kgf • cm	30Kgf • cm	50Kgf • cm
Max. Gear breaking torque	15Kgf • cm	80Kgf • cm	150Kgf • cm
Max. Gearing efficiency	73%	65%	59%
Other reduction ratio please telephone or e-mail to our engineering department.			

### Motor Data:

Motor name	Rated Volt. V	No load		Load torque				Stall torque	
		Current	Speed	Current	Speed	Torque	Output power	Torque	Current
		mA	r/min	mA	r/min	gf • cm	W	gf • cm	mA
DS-555123000	12	≤140	3000	≤800	2200	150	3.3	600	3000
DS-555124500	12	≤220	4500	≤1200	3300	220	7.2	880	4800
DS-555126000	12	≤350	6000	≤2000	4500	300	13.5	1200	6000
DS-555243000	24	≤70	3000	≤400	2200	150	3.3	600	1600
DS-555244500	24	≤110	4500	≤600	3300	220	7.2	880	3000
DS-555246000	24	≤180	6000	≤1000	4500	300	13.5	1200	4000

Remarks: After connecting motor and gearbox(named gear motor),the output torque of gear motor=driving motor torque\*gear reduction ration\*gearing efficiency; Output speed of gear motor = Driving motor speed/gear reduction ration.

### NOTE:

1. Gear motor named methods:e.g.DS-95SS555,as for Driving Motor, please refer to the motor data of 36ZY123000;Gearbox, please refer to gearbox data of reduction ration 90.Related to the gear motor output speed & torque,please refer to the remarks in driving motor data;
2. Motor can be installed with magnetic encoder,for more details,pls refer to our company website;
3. Standard output shaft after reducing:  $\phi$  6.0mm,othersizes of the output shaft can be made as client's request;
4. The gear materials can be plastic,powder metallurgy,or 45# steel after heat-treatment;