



## DS-28RP395 DC PLANETARY GEAR MOTOR

基本电压/Main voltage: 6VDC, 12VDC, 24VDC

### 典型应用/Typical applications:

光学设备、摄像机、电子锁、自动节能浴具、水IC卡、玩具和礼品、办公设备、家用电器、自动执行机构  
Optical equipment, CCTV camera, electric lock, automatic bath necessities, water IC Card, toys and gifts, office equipments, household appliances, automatic actuator

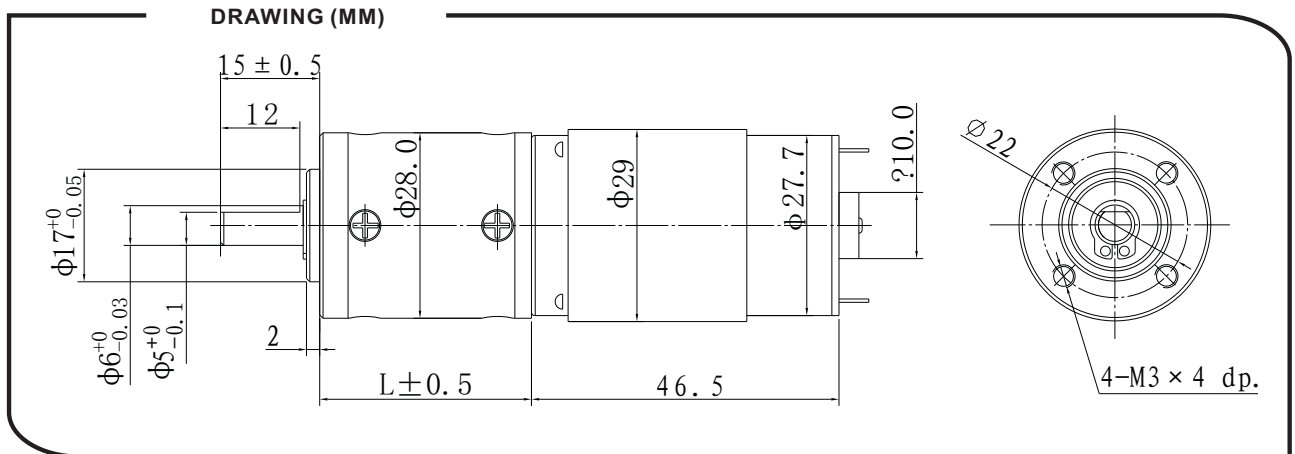

### 齿轮箱参数/Gearbox data:

段数 Number of stage	1	2	3	4
减速比 Reduction ratio	3.7, 5.2	14, 19, 27	51; 71, 100, 139	189; 264, 369, 515, 721
齿轮箱长度 Gearbox length "L" mm	27.5	35.5	43.5	51.5
额定扭矩 Rated torque(Kgf.cm)	3	6	8 ; 10	15 ; 20
破坏扭矩 Breaking torque(Kgf.cm)	6	10	15 ; 20	30 ; 40
齿轮箱效率 Gearbox efficiency	90%	81%	72%	65%

### 电机参数/Motor data:

电机型号 Motor model	额定电压 Rated Volt.	空载/No load		负载/Load				堵转/Stall	
		电流	转速	电流	转速	扭矩	功率	扭矩	电流
		Current	Speed	Current	Speed	Torque	Power	Torque	Current
	V	mA	r/min	mA	r/min	gf · cm	W	gf · cm	mA
DS-395123000	12	≤60	3000	≤250	2200	65	1.4	260	800
DS-395124500	12	≤90	4500	≤430	3300	80	2.6	320	1400
DS-395126000	12	≤130	6000	≤750	4500	105	4.7	420	2600
DS-395243000	24	≤40	3000	≤120	2200	65	1.4	260	400
DS-395244500	24	≤50	4500	≤220	3300	80	2.6	320	700
DS-395246000	24	≤70	6000	≤380	4500	105	4.7	420	1400

齿轮箱电机输出扭矩: 电机输出扭矩 x 减速比 x 齿轮箱效率; 齿轮箱电机输出转速: 电机输出转速 / 减速比。  
Output torque of gear motor : Output torque of motor x Reduction ratio x Gearbox efficiency;  
Output speed of gear motor: Output speed of motor / Reduction ratio.